

ZGL120070



Constant Current Discharge Rating Amperes @ 25°C (77°F)

FV/Time	5M	10M	15M	30M	1HR	2HR	3HR	4HR	5HR	8HR	10HR	20HR
10.5	199.5	147.1	122.4	81.97	47.62	26.6	19.27	15.9	12.9	9.08	7.650	3.938

Characteristics

Capacity	20 hour rate	80AH	
25°C (77°F)	5 hour rate	68AH	
Internal Resistance	Full charged Battery 25°C (77°F)	6mΩ	
Capacity affected by Temperature (20 hour rate)	40°C (104°F)	107%	
	25°C (77°F)	100%	
	0°C (32°F)	76%	
	-10°C (14°F)	66%	
Self-Discharge	Batteries can be stored for more than 6 months at 25°C. Self-discharge ratio less than 3% per month at 25°C. Please charge batteries before using.		
Standard Terminal	M6		
Max. Discharge Current 25°C (77°F)	750A (5s)		
Final Discharge Voltage V/cell	1.75V	1.70V	1.60V
	(A) ≤ 0.2C	0.2 < (A) < 1.0C	(A) ≥ 1.0C
	Charging (Constant Voltage)	Cycle Initial Charging Current 22.5A Or Small 14.6V~14.8V/ 25°C (77°F) Float 13.6V~13.8V/ 25°C (77°F)	
Container Material	A.B.S. (UL94-HB), Flammability resistance of UL94-V1 can be available upon request.		

Specifications

Nominal Voltage	12V	
Rated Capacity (20 hour rate)	80Ah	
Dimension	Total Height (with terminals)	215mm (8.471 inches)
	Height	210mm (7.092 inches)
	Length	260mm (13.79 inches)
	Width	169mm (6.57 inches)
Weight	Approx. 23.5 kg (52.8lbs)	

Discharge characteristics 25°C (77°F)

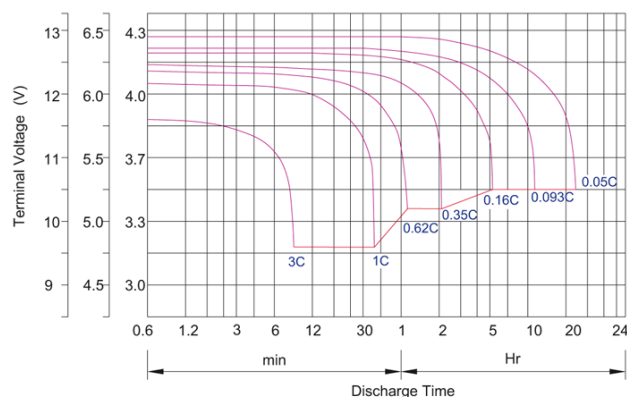

Charge characteristic Curve for standby use

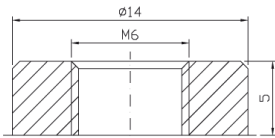
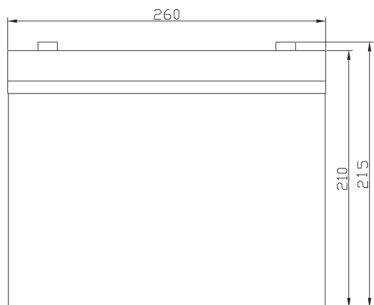
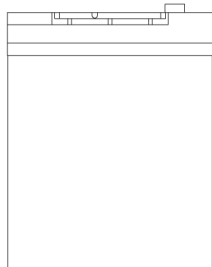
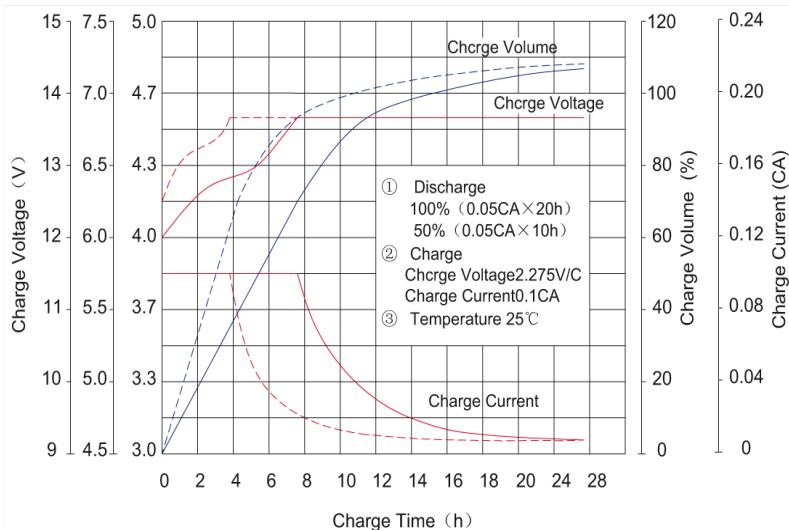

This information is generally descriptive only and is not intended to make or imply any representation, guarantee or warranty with respect to any cells and batteries. Cell and battery designs/specification are subject to modification without notice. Contact U.B.S. UNION BATTERY SERVICE for the latest information.

DIVISION OF



www.zenithdcbattery.com